

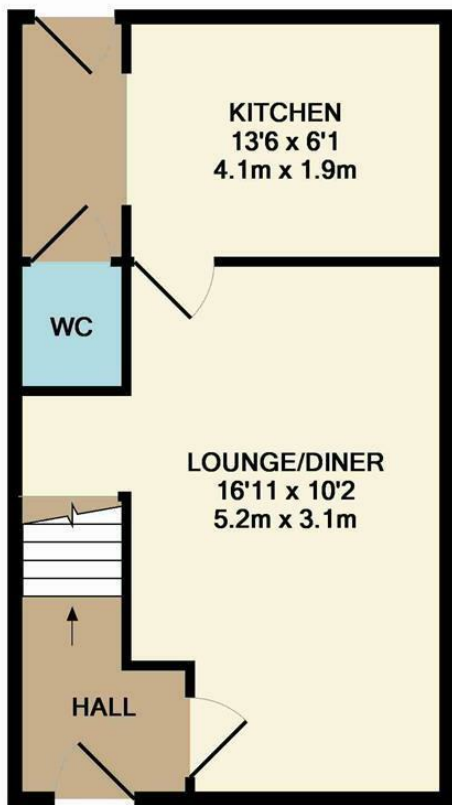

Havers Road | Norwich | NR3
 Guide Price £260,000

abbotFox



GROUND FLOOR

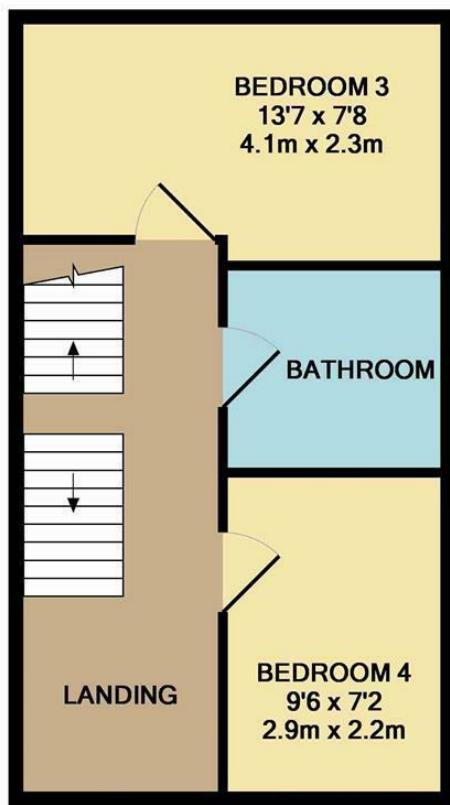

1ST FLOOR

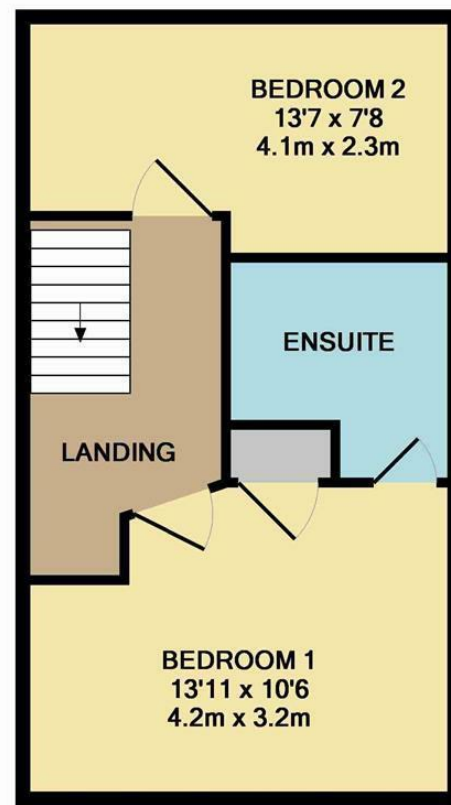

2ND FLOOR

Whilst every attempt has been made to ensure the accuracy of the floor plan contained here, measurements of doors, windows, rooms and any other items are approximate and no responsibility is taken for any error, omission, or mis-statement. This plan is for illustrative purposes only and should be used as such by any prospective purchaser. The services, systems and appliances shown have not been tested and no guarantee as to their operability or efficiency can be given
 Made with Metropix ©2015

Energy Efficiency Rating		
	Current	Potential
Very energy efficient - lower running costs		
(92 plus) A		
(81-91) B		
(69-80) C		
(55-68) D		
(39-54) E		
(21-38) F		
(1-20) G		
Not energy efficient - higher running costs		
England & Wales		EU Directive 2002/91/EC

Disclaimer – In accordance with the Property Misdescriptions Act, the company gives notice that all descriptions, references to condition, necessary permissions for use and other details are given in good faith and believed to be correct, but any intending lessees do not rely on them as statements of fact, but must satisfy themselves by inspection or other means, as to their accuracy.



abbotFox presents this spacious, three storey, end terraced town house. Situated within easy reach of a variety of local amenities, this is an ideal opportunity for any young family or buy-to-let investor. With accommodation over three floors, the property offers a high degree of flexibility, with the ground floor offering an inviting entrance hall, cloakroom, lounge diner and kitchen. The first floor provides two comfortable bedrooms and a family bathroom. The top floor comprises two further bedrooms, with an en-suite shower room. Externally, this home offers an enclosed, private rear garden with allocated parking. Having been well maintained and improved by the current owner, an internal viewing comes highly recommended.

Guide Price £260,000-£270,000

